

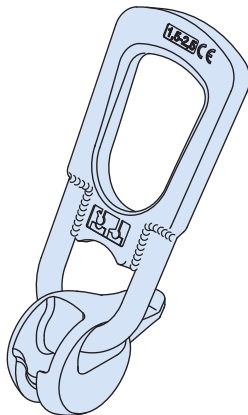

DEHA SPHERICAL HEAD LIFTING ANCHOR SYSTEM

Lifting Links

Universal head lifting link



The DEHA Universal head lifting link is used for lifting and transporting precast concrete elements with cast in spherical head anchors. The universal head lifting link is a manual-release link. The universal head links currently available are Chrom-6-free zinc galvanised.

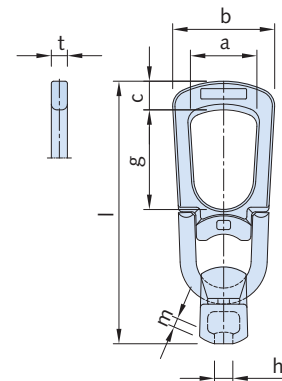

Allowable loads for each particular case can be found in the respective tables. In general the safety regulations in the country of use are to be observed, in particular those for the use of cranes and lifting equipment.

Dimensions of universal head lifting link

| Load class | Article number | Order no. 0738.010- | Weight [kg] | a [mm] | b [mm] | c [mm] | g [mm] | h [mm] | t [mm] | l [mm] | m [mm] |
|---------------|----------------|---------------------|-------------|--------|--------|--------|--------|--------|--------|--------|--------|
| 1.3 | 6102-1,3 | 00001 | 0.9 | 47 | 75 | 20 | 71 | 11 | 12 | 188 | 7.0 |
| 2.5 | 6102-2,5 | 00002 | 1.4 | 59 | 91 | 25 | 86 | 16 | 14 | 230 | 8.5 |
| 4.0 and 5.0 | 6102-5,0 | 00003 | 3.4 | 70 | 118 | 37 | 88 | 21 | 16 | 283 | 10.0 |
| 7.5 and 10.0 | 6102-10,0 | 00004 | 9.1 | 88 | 160 | 50 | 115 | 30 | 25 | 401 | 14.0 |
| 15.0 and 20.0 | 6102-20,0 | 00005 | 21.0 | 106 | 180 | 75 | 135 | 41 | 30 | 506 | 21.0 |
| 32.0 | 6102-32,0 | 00006 | 47.0 | 172 | 272 | 100 | 189 | 52 | 40 | 680 | 28.5 |
| 45.0 | 6102-45,0 | 00007 | 59.0 | 179 | 349 | 100 | 192 | 52 | 40 | 676 | 28.5 |

Identification

Each universal head lifting link is identified as shown: the name of the manufacturer (DEHA) is stamped into the handle together with the application identifier K-A and the unique anchor number. The load class, the CE mark and an operating symbol can be found on the rear of the handle.

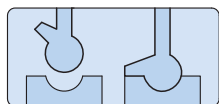

The ball is marked with the batch number and year of manufacture.

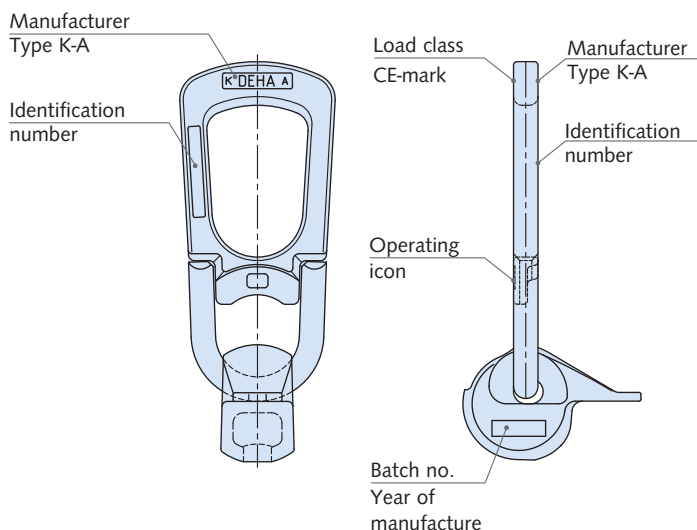

The application identifier K-A denotes that the universal head lifting link can be used for the following two DEHA Lifting anchor systems:

- for the DEHA Lifting anchor system type **K** with the spherical head anchor
- for the DEHA Lifting anchor system type **A** with an appropriate cast-in socket and adaptor.