

Weld-On Hook Powertex WH

Product information



Enhance your lifting and handling operations with the Powertex Weld-on Hook WH, a robust and reliable solution for welded mounting on lifting beams, excavators, and other earth-moving machinery. Engineered to meet the rigorous demands of industrial environments, the WH hook ensures secure and efficient load handling.

Allowed loading directions:

- The WH hook is designed to be loaded within a 135-degree area in the intended load plane (+45 to -90 degrees from the weld-on surface)

Product features:

Durable finish: Coated in PURE RED powder paint, the WH Weld-on hooks stand out for their durability and corrosion resistance.

Ready for welding: The weld base is not painted, allowing for immediate welding without excessive smoke or fumes.

Compliance to standard: Manufactured to meet the testing requirements specified by EN 1677-1 and AS 3776, ensuring high safety and quality standards.

Reliable: Designed with a safety factor of at least 4 in the intended load directions, offering a secure lifting experience. Safety factor of 5 when loaded parallel to the weld base.

Quality assurance: Each component undergoes crack detection testing and sample proof loading in the factory.

Type testing: Each model undergoes factory type testing, including breaking tests and a fatigue test to 20,000 cycles at 1.5 times the WLL, which highlights the product's endurance.

Full traceability: Every component is marked with POWERTEX branding, model name, WLL, CE-mark, UKCA-mark, and a traceability code, ensuring traceability to the production lot and raw materials [... Read more](#)

Features: Weldable base prepared for immediate welding, spare part kits available

Material: Forged Alloy Steel

Marking: CE-marked, UKCA-marked, Powertex, model name, WLL and batch number

Temperature range: -40°C up to +200°C

Finish: Powder painted in PURE RED

Note: The LPW is WLL (Working Load Limit) rated, assuming that the correct welding procedure is meticulously followed and executed by a suitably qualified welder, to maintain the product's integrity and compliance with safety regulations.

Weld-On Hook Powertex WH

Blueprint

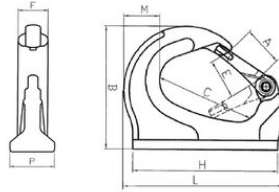

Technical data

Part code	Code	WLL ton	A mm	B mm	C mm	E mm	F mm	H mm	M mm	L mm	P mm	Weight kg
420500101250	WH-1T	1	23	76	63	22	18	93	22.5	101	25	0.54
420500201250	WH-2T	2	29	92	66	26	20.5	81	23.3	111	34	0.87
420500301250	WH-3T	3	30	106	75	30	24	116	30	128	36	1.3
420500501250	WH-5T	5	39	133	98	36	28	160	43	176	43.5	2.7
420500801250	WH-8T	8	36	137	99	34.5	39	166	50	175	51	3.5
420501001250	WH-10T	10	49	169	140	49	38	205	55	222	53	5.2